

Level 10 - 930 sqm (10,000 sqft)

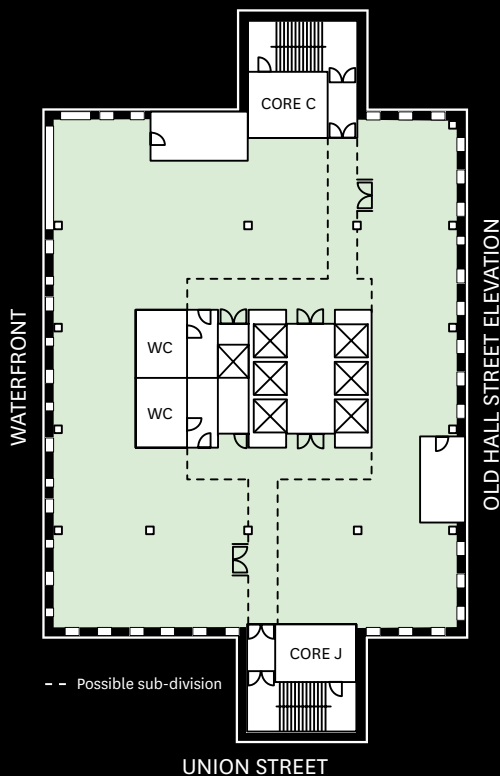

Welcome to the building that offers so much more. Just as The Capital's stature imposes itself on Liverpool's World Heritage Waterfront so too the quality of accommodation – and influence of the businesses it houses – will dominate the city's new commercial core. Every detail of specification has been carefully conceived and the landlord's on-site management and security provision ensures an unrivalled business environment. Step outside The Capital and you're in a city that offers an exceptional work-life balance; with hotels, restaurants, shops, galleries and museums within an easy stroll.



- Prestigious reception with comfortable break-out areas
- 6 new eighteen-person lifts with efficient destination control system
- Luxurious washrooms and toilets with shower facilities
- Full air-conditioning utilising ground-water from Mersey Tunnels
- Uninterruptible Power Supply (UPS)
- White noise system
- 24-hour on-site security and CCTV
- Over 1,100 secure on-site parking spaces
- Suspended ceilings with PIR sensed LG7 lighting
- Full-access 150mm raised floor
- Efficient floor plates with high ceilings and full-height glazing

WWW.THECAPITALBUILDING.CO.UK