

Level 5 - 1,590 sqm (17,117 sqft)

Available for single occupancy, or can be subdivided to provide up to 3 suites

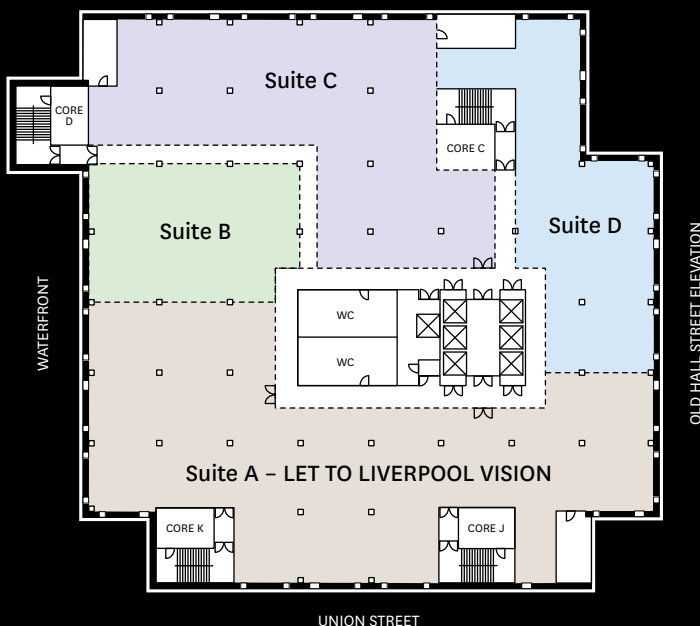

Welcome to the building that offers so much more. Just as The Capital's stature imposes itself on Liverpool's World Heritage Waterfront so too the quality of accommodation – and influence of the businesses it houses – will dominate the city's new commercial core. Every detail of specification has been carefully conceived and the landlord's on-site management and security provision ensures an unrivalled business environment. Step outside The Capital and you're in a city that offers an exceptional work-life balance; with hotels, restaurants, shops, galleries and museums within an easy stroll.



SUITE B	340 sqm	3,661 sqft
SUITE C	730 sqm	7,863 sqft
SUITE D	460 sqm	4,952 sqft

Available for single occupancy of 1,590 sqm (17,117 sqft), or can be subdivided to provide up to 3 suites

- Prestigious reception with comfortable break-out areas
- 6 new eighteen-person lifts with efficient destination control system
- Luxurious washrooms and toilets with shower facilities
- Full air-conditioning utilising ground-water from Mersey Tunnels
- Uninterruptible Power Supply (UPS)
- White noise system
- 24-hour on-site security and CCTV
- Over 1,100 secure on-site parking spaces
- Suspended ceilings with PIR sensed LG7 lighting
- Full-access 150mm raised floor
- Efficient floor plates with high ceilings and full-height glazing

WWW.THECAPITALBUILDING.CO.UK